

**Model 801 Offset Mount Adapter
For New Holland 9030 & TV140
Bi-Directional Tractors**

PARTS CATALOG

TABLE OF CONTENTS

Frame & Float Group.....	2,3
Wheel Assembly.....	4,5
Hydraulics.....	6-9
Electrical.....	10,11
Header Completion Group	12,13
Decals.....	14,15
<u>NUMERICAL LIST</u>	16

ABBREVIATIONS

L/H - left hand (Determined from Operator's position, facing forward.)

R/H - right hand

I.D. - inside diameter

O.D. - outside diameter

A/R - as required (quantity varies)

REF - reference, part number called up elsewhere in catalog

SUB - Substitute (Revised design may be used to repair previous design when stock is depleted.)

NC - national coarse thread

NF - national fine thread

NOTE: Common hardware is not illustrated. Alphabetic references are used to designate position and description of these items.

When ordering, be sure the complete and proper serial number is given.

SERIAL NUMBER BREAKS

The side of the serial number on which the dash (-) appears determines whether the part is used "up to" or "after" the serial number given.

Example:	-74924	Used on machines up to and including serial number 74924.
	74925-	Used on machines including and after serial number 74925.

FRAME & FLOAT GROUP

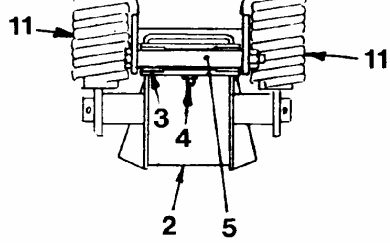
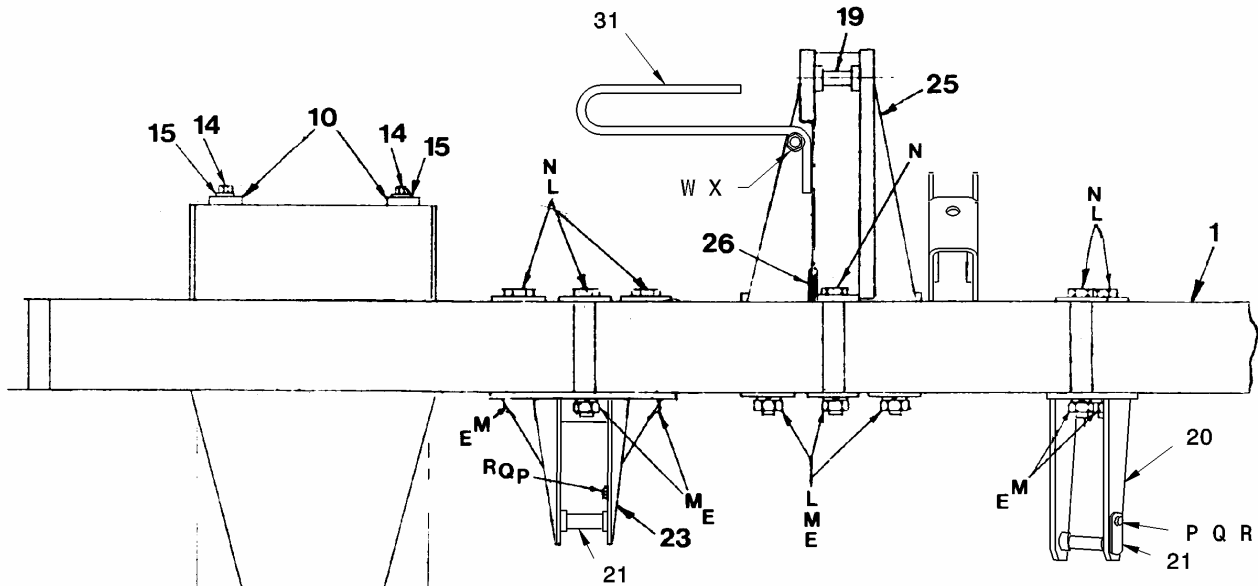

REAR VIEW

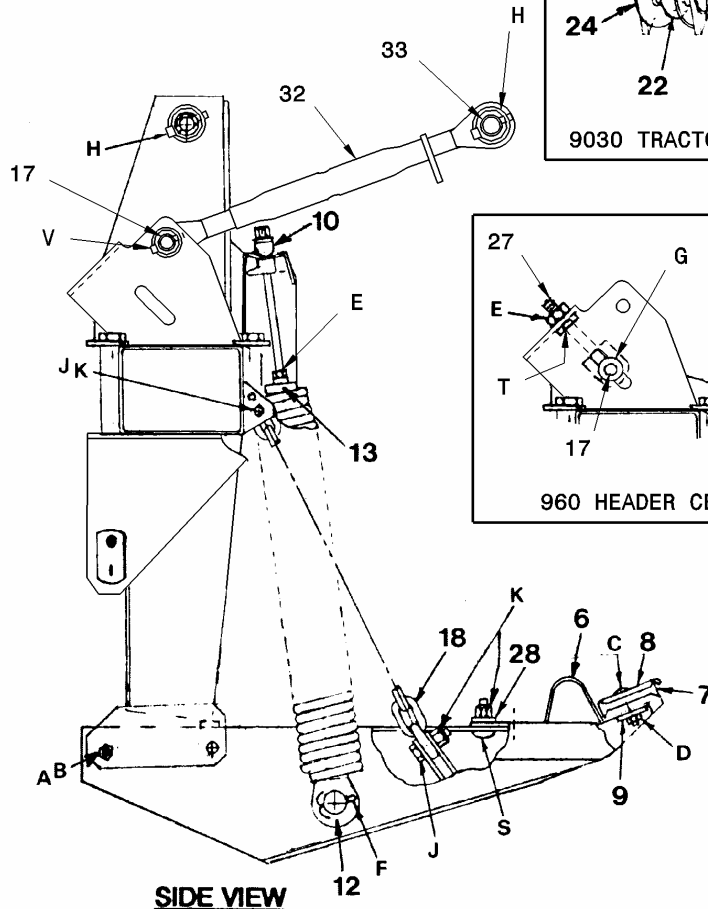
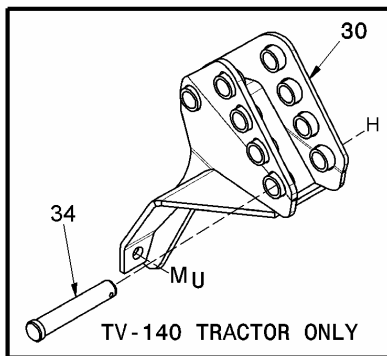
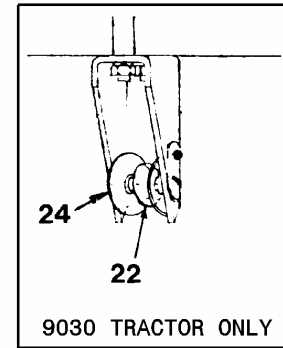

SIDE VIEW

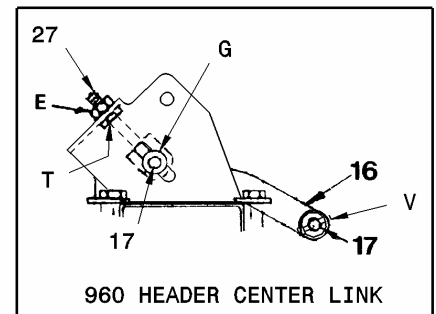

FRAME & FLOAT GROUP

REF	PART NUMBER	DESCRIPTION	QTY.	SERIAL NUMBER	
1	108121	FRAME – adapter, with decals.....	1		
2	40691	ARM – float, with bushings & lube fitting.....	2		
3	1134	BUSHING – bronze.....	4		
4	18671	FITTING – lube.....	2		
5	40611	SPACER – tube.....	2		
6	40545	SUPPORT – lower leg.....	2		
7	42498	PAD – rubber.....	2		
8	44575	PLATE – cover.....	2		
9	11695	WASHER – flat.....	2		
10	36837	PIVOT – float spring.....	4		
11	42690	SPRING – float, standard	4		
	45858	SPRING – float, upgraded, see note 1	4		
12	42691	INSERT – spring, lower.....	4		
13	24322	INSERT – spring, upper.....	4		
14	41122	DRAWBOLT – spring.....	4		
15	21540	WASHER – hardened.....	4		
16	40613	LINK – center, 960 Header.....	1		
17	20312	PIN – clevis, ¾ x 3 ¼ inch effective length (qty. 2 for 960 Hdr).....	1		
18	40554	CHAIN – linkage.....	2		
19	49341	PIN – upper link.....	1		
20	40615	SUPPORT – lower link, two-bolt.....	1		
21	40617	PIN – lower link.....	2		
22	50106	BALL – lower link, 9030 Tractor only.....	2		
23	108099	SUPPORT – lower link, three-bolt.....	1		
24	40720	WASHER – formed, 9030 Tractor only.....	4		
25	40758	ANCHOR – upper link, with decals.....	1		
26	25298	PROTECTOR – hose/wiring.....	3		
27	37635	CLEVIS – center link adjustment, 960 Header.....	1		
28	22072	WASHER – flat.....	4		
30	108505	SUPPORT – tractor upper link, TV140 Tractor only (was 108098)	1	see note 2	
31	REF	SUPPORT – hose, see “Hydraulics”.....	1		
32	108161	JOINT ASSEMBLY – center link, 962 & 972 Headers.....	1		
33	158635	PIN – clevis, 1 x 3.35 inch eff. length, 962 & 972 Headers	1		
34	135006	PIN – clevis, 28mm x 140mm effective length	1		
35	108524	KIT – upper link upgrade incl. items 30, 34, H, M, U & instr	1		
A	50107	BOLT – hex head, ¾ NC x 8 ½ inch	M	18640	WASHER – lock, ¾ inch
B	18689	NUT – lock, ¾ NC distorted thread	N	30597	BOLT – hex head, ¾ NC x 8 inch
C	30266	BOLT – round head, sq nk, ½ NC x 3 inch	P	21264	BOLT – hex head, 3/8 NC x 1 ¼ inch
D	21389	NUT – lock, ½ NC nylon insert	Q	18590	NUT – hex, 3/8 NC
E	18593	NUT – hex, ¾ NC	R	30228	NUT – lock, smth flange, 3/8 NC dist. Thd.
F	18610	PIN – cotter, ¼ x 2 ½ inch	S	18523	BOLT – rnd hd, sq nk, 5/8 NC x 1 ½ inch
G	18601	WASHER – flat, 13/16 inch ID	T	21378	NUT – hex jam, ¾ NC
H	102264	PIN – lynch, 3/16 x 1 9/16 inch	U	135010	BOLT – hex head, 3/4 NC x 1-3/4 inch
J	21587	BOLT – hex head, 5/8 NC x 2 inch	V	50193	PIN – lynch, 3/16 x 1 ¼ inch
K	18666	NUT – lock, 5/8 NC distorted thread	W	18723	BOLT – hex head, ½ NC x 1 ½ inch
L	16235	WASHER – flt, 1.7 OD x 0.81 ID x ¼ in thk	X	50186	NUT – lock, smth flange, ½ NC dist. thread

NOTE: 1). If float upgrade is required order kit 108522, which includes 2 of spring 45858 and installation instructions. If float upgrade is required on both sides of adapter, two kits will be required.

2). If replacing support 108098 order kit item 35.

WHEEL ASSEMBLY

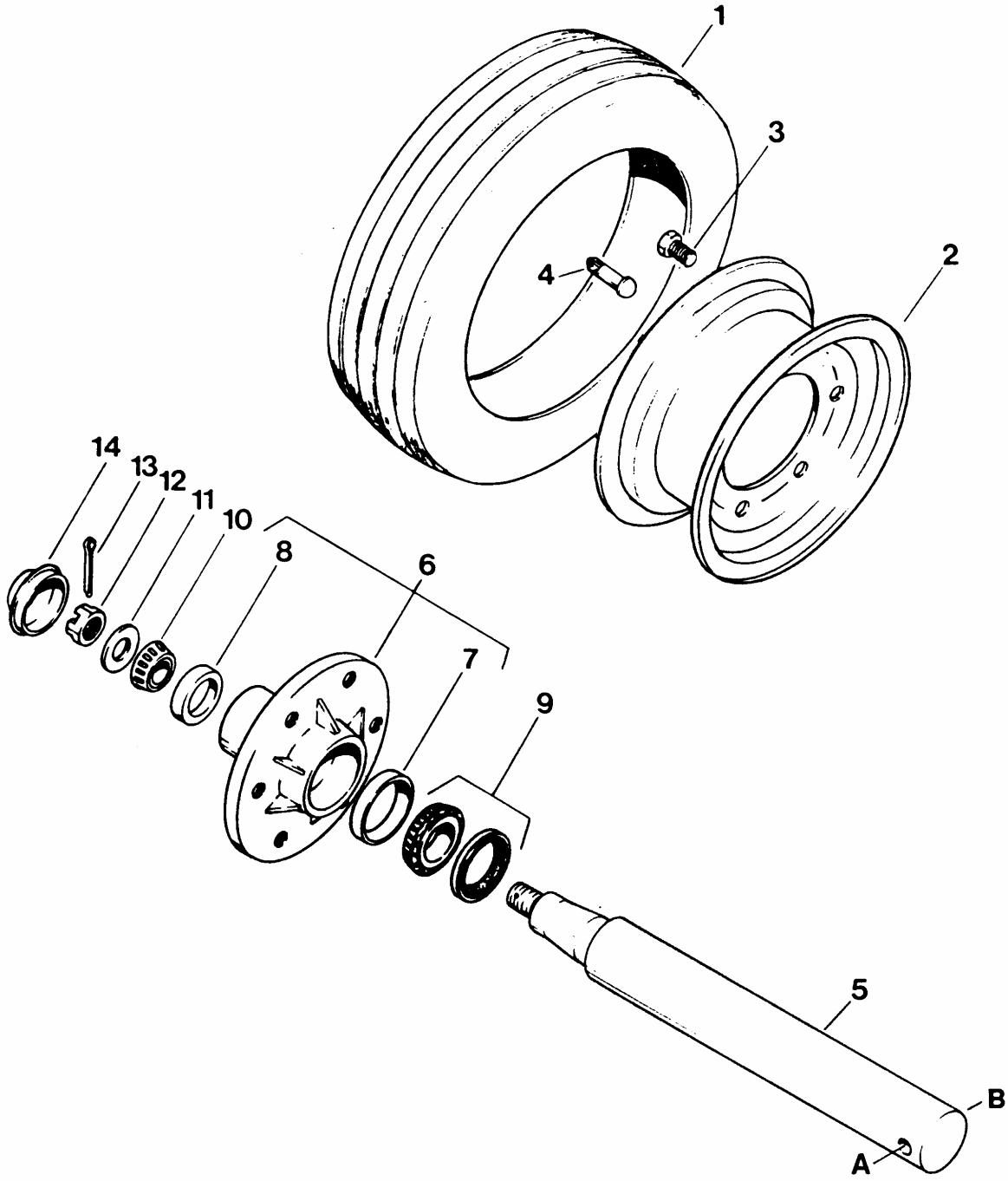

WHEEL ASSEMBLY

REF	PART NUMBER	DESCRIPTION	QTY.	SERIAL NUMBER
1	30446	TIRE – 9.5L-14 Rib Implement.....	1	
2	30758	WHEEL – 6 bolt.....	1	
3	21719	BOLT – wheel	6	
4	21395	STEM – valve	1	
5	41155	SPINDLE – wheel	1	
6	30521	HUB – with cups, items 7 and 8	1	
7	30516	BEARING – cup, inner	1	
8	7900	BEARING – cup, outer	1	
9	30517	BEARING – cone, with seal	1	
10	21376	BEARING – cone.....	1	
11	21540	WASHER – flat, hardened.....	1	
12	5512	NUT – hex slotted, ¾ NF.....	1	
13	18648	PIN – cotter.....	1	
14	30520	CAP – dust	1	
A	21560	BOLT – hex head, ½ NC x 3 inch		
B	50186	NUT – lock, smooth flange, ½ NC distorted thread		

HYDRAULICS

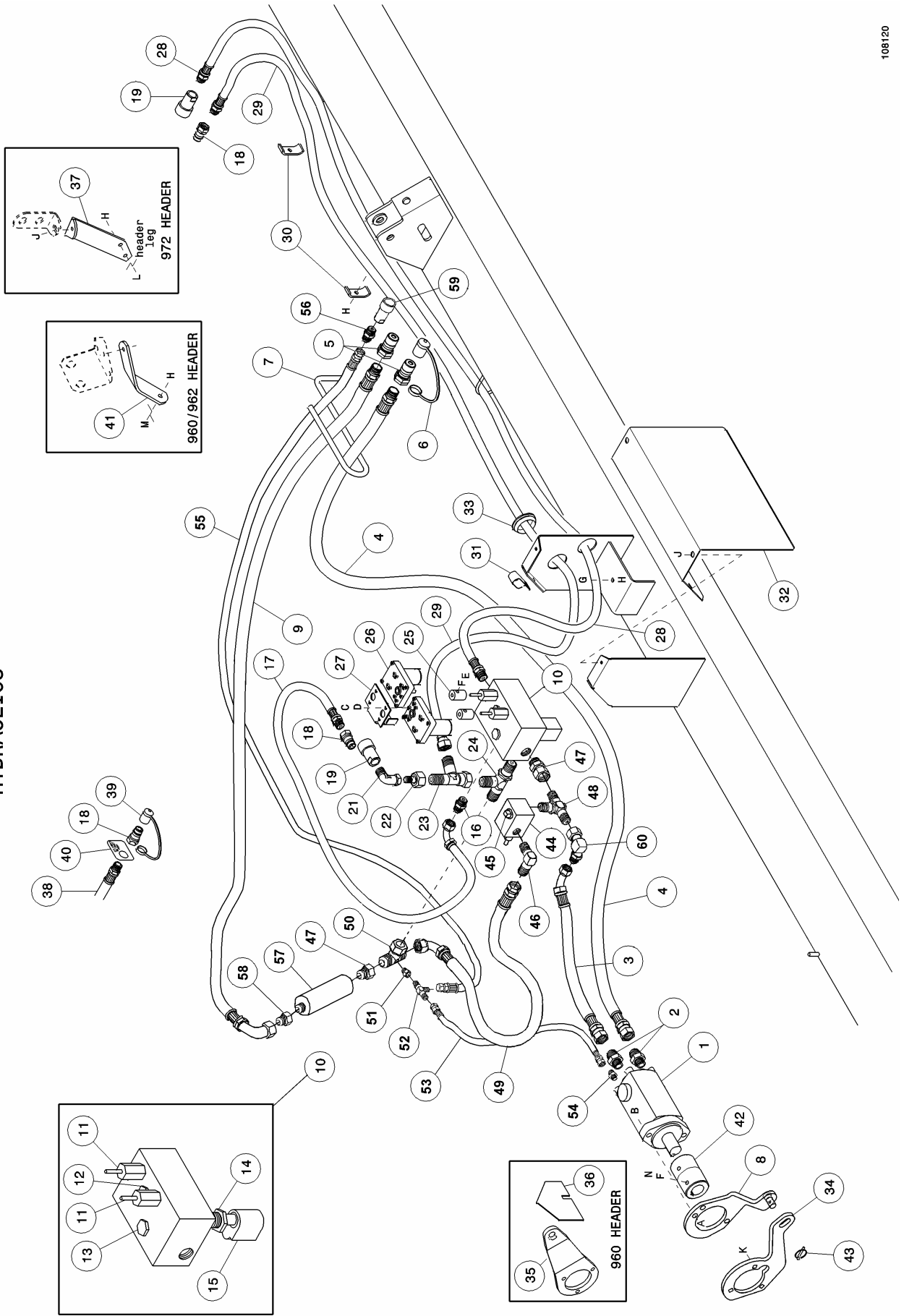

HYDRAULICS

REF	PART NUMBER	DESCRIPTION	QTY.	SERIAL NUMBER
1	108063	MOTOR – hydraulic	1	
	40569	SEAL KIT – for motor 108063		
2	30610	FITTING – adapter, 7/8 O-ring x ¾ tube	2	
	44210	O-RING – for 7/8 fitting		
3	108093	HOSE – motor “A” port to valve “P” port	1	
4	108515	HOSE – motor “B” port to tractor PRESSURE coupler (was 108090)...	1	
5	30871	COUPLER – male, 1 1/16 ORB	2	
6	50105	CAP – dust, for coupler 30871	2	
7	108160	SUPPORT – hose	1	
8	108133	ARM – torque, motor mounted	1	
9	108516	HOSE – tractor RETURN coupler to valve “T” port (was 108092)	1	
10	108519	VALVE – combination, includes items 11-15 (was 108067)	1	
	45101	SEAL KIT – repairs <i>one</i> valve cartridge		
11	45109	FLOW CONTROL.....	2	
	45123	SETSCREW – for flow control 45109		
12	45110	VALVE – shuttle	1	
13	45111	VALVE – regulator	1	
14	45107	VALVE – N.C.....	1	
15	45104	COIL – DS, 12VDC	1	
16	30695	FITTING – adapter, 7/8 O-ring x 5/8 tube	1	
	44210	O-RING – for 7/8 fitting		
17	40512	HOSE – valve “C” port to header draper pressure hose.....	1	
18	21855	COUPLER – male, ½ NPT	3	
19	21857	COUPLER – female, ½ NPT	3	
	50082	O-RING – for coupler 21857		
20	21830	FITTING – adapter, 1 1/16 O-ring x ¾ tube	1	
	30971	O-RING – for 1 1/16 fitting		
21	50018	FITTING – elbow, 90°, 5/8 tube female x ½ NPT male.....	1	
22	30973	FITTING – reducer, 5/8 tube male x ¾ tube female.....	1	
23	50086	FITTING – swivel run tee, ¾ tube male (2) x ¾ tube female	1	
24	30858	FITTING – straight thread run, ¾ tube male (2) x 1 1/16 O-ring.....	1	
	30971	O-RING – for 1 1/16 fitting		
25	40567	HUB – connector, electric motor to valve	2	
26	42369	MOTOR – electric	2	
27	40682	STOP – motor.....	1	
28	43617	HOSE – valve “R” port to header reel pressure hose	1	
29	108141	HOSE – header reel return to tee at valve	1	
30	32225	HOLDER – hose	2	
31	103738	HOLDER – hose	1	
32	108110	COVER – valve assembly	1	
33	45298	GROMMET	2	
34	108134	ARM – torque, header mounted, 962 & 972 Headers.....	1	
35	108136	ARM – torque, header mounted, 960 Header	1	
36	108155	SHIELD – motor drive, 960 Header.....	1	
37	108175	SUPPORT – reel coupler mount, 972 2-Reel Arm Headers	1	
38	36848	HOSE – reel lift extension, 960 & 962 Headers	1	
	40333	HOSE – reel lift extension, 972 Header	1	
39	21856	CAP – dust, for coupler 21855	1	
40	49417	TAG – hose routing instruction.....	1	
41	40695	SUPPORT – reel drive coupler mount, 960 & 962 Headers	1	
42	108065	COUPLING – motor, 1 3/8 inch shaft, 962 & 972 Headers.....	1	
	108066	COUPLING – motor, 1 3/16 inch shaft, 960 Header	1	
43	50193	PIN – lynch	1	

HYDRAULICS

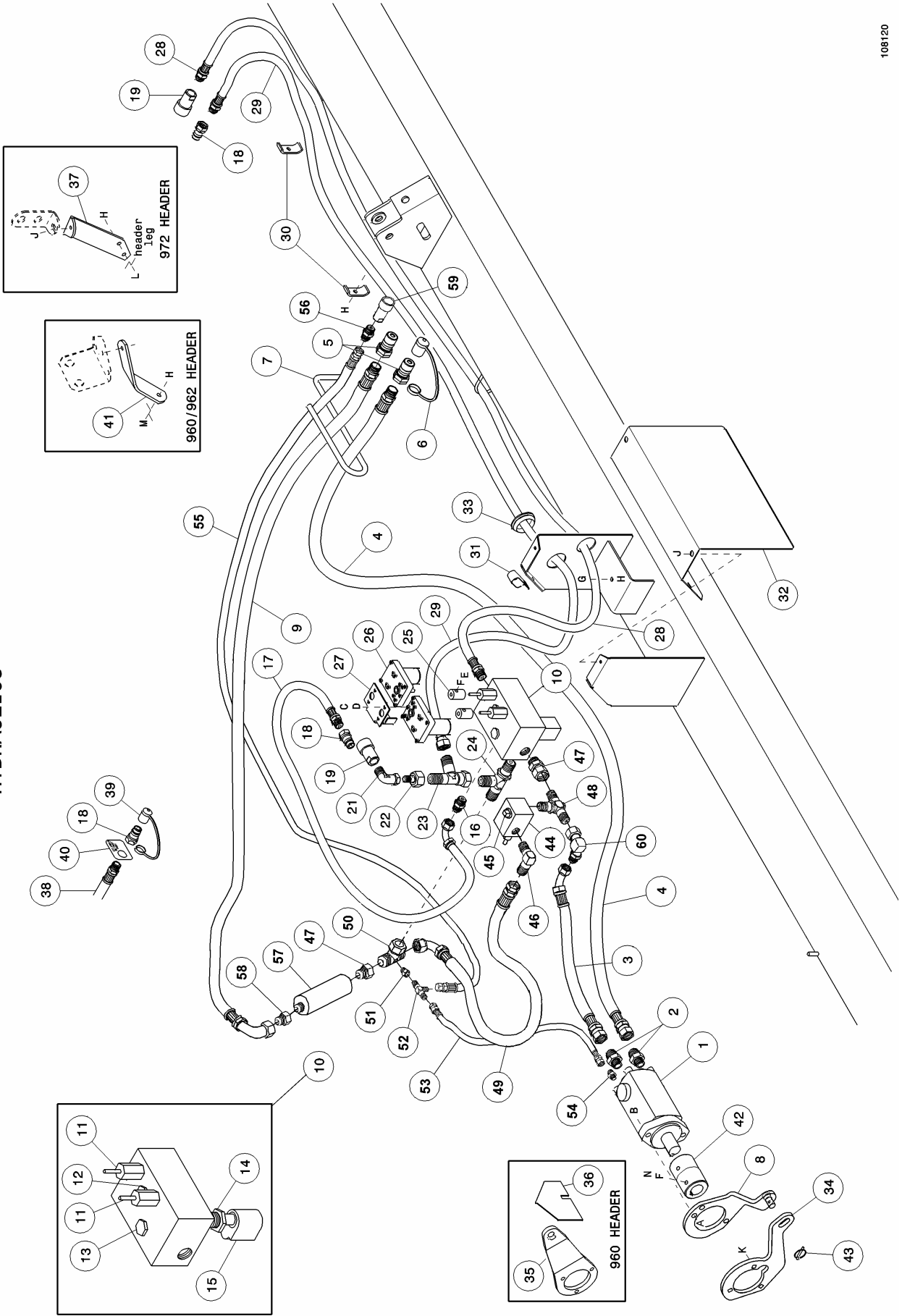

HYDRAULICS

REF	PART NUMBER	DESCRIPTION	QTY.	SERIAL NUMBER
44	24508	VALVE - hydraulic	1	
45	30262	FITTING – hydraulic, sq hd, 1/2 in. npt, magnetic	1	
46	50077	FITTING – hydraulic, 90° elbow, sae 12-8	1	
47	40241	FITTING – hydraulic, connector, sae 12-12 male/female (was 21830).	2	
48	21832	FITTING – hydraulic, tee, sae 12-12-8.....	1	
49	44195	HOSE – hydraulic	1	
50	108513	FITTING – hydraulic tee, special, with ¼ npt tap in side	1	
51	108502	FITTING – hydraulic, restrictor, 0.0935 orifice.....	1	
52	135005	FITTING – hydraulic, tee, ¼ pipe x 6 JIC x 6 JIC	1	
53	31802	HOSE – hydraulic	1	
54	100790	FITTING – hydraulic, adapter, sae 6-4	1	
55	31805	HOSE – hydraulic	1	
56	114141	FITTING – hydraulic, adapter, sae 6-10	1	
57	108501	VALVE – hydraulic, check	1	
58	21830	FITTING – hydraulic, connector, sae 12-12.....	1	
59	108226	COUPLING – hydraulic, .500 in. #10 orb	1	
60	108521	FITTING – elbow, 90° elbow, sae 12-12 male/female, 1/4npt tap in side.....	1	
61	21858	PLUG – hydraulic, dust.....	1	
A	21565	BOLT – hex head, ½ NC x 1 ¾ inch		
B	18697	NUT – lock, ½ NC distorted thread		
C	30955	SCREW – machine, #8 x 5/16 inch		
D	21185	WASHER – lock, #10 internal tooth		
E	21248	SCREW – set, 3/8 NC x ¾ inch		
F	18664	NUT – hex jam, 3/8 NC		
G	21593	BOLT – hex head, 3/8 NC x 4 inch		
H	30228	NUT – lock, smooth flange, 3/8 NC distorted thread		
J	101898	SCREW – flange head, self-tapping, 3/8 x 5/8 inch		
K	19966	BOLT – round head, square neck, 3/8 NC x 1 ¼ inch		
L	19965	BOLT – round head, square neck, 3/8 NC x 1 inch		
M	21863	BOLT – round head, short square neck, 3/8 NC x ¾ inch		
N	18908	SCREW – set, 3/8 NC x 1 inch		

ELECTRICAL

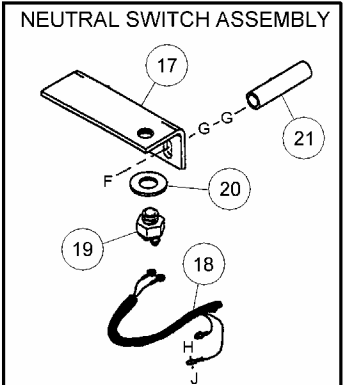
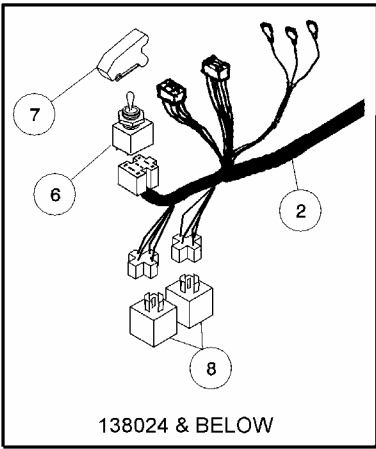
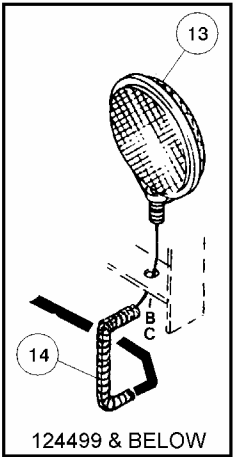
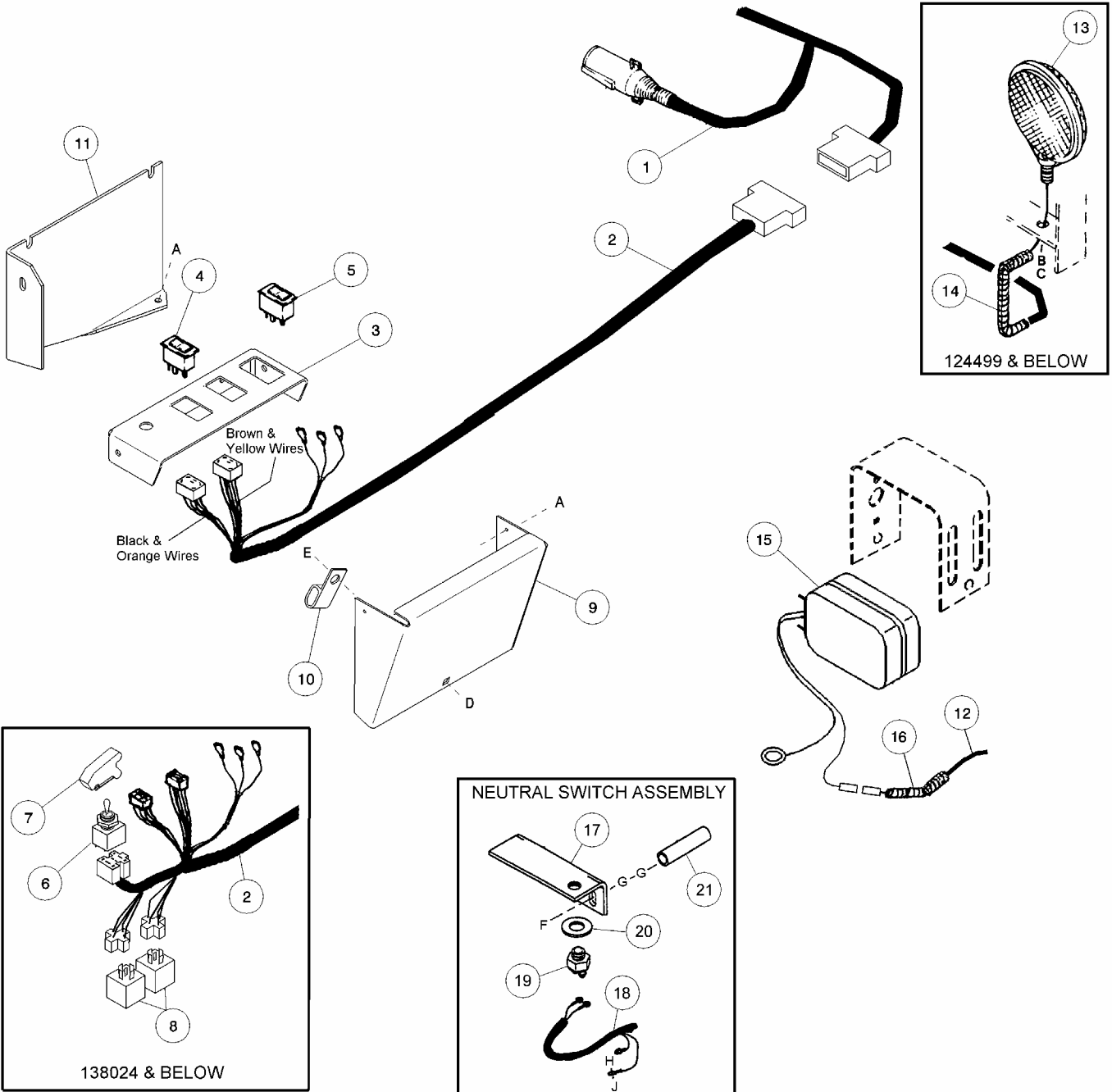

ELECTRICAL

REF	PART NUMBER	DESCRIPTION	QTY.	SERIAL NUMBER
1	108077	HARNESS – wiring, adapter section	1	
	30710	PLUG – 7-pole, included with harness 108077		
2	108080	HARNESS – wiring, switch panel section	1	-124499
	108267	HARNESS – wiring, switch panel section	1	124500-131619
	108523	HARNESS – wiring, switch panel section	1	131620-
3	108082	PANEL – switch, with decal.....	1	-131619
	108284	PANEL – switch, with decal.....	1	131620-
4	42256	SWITCH – reel and draper speed	2	
5	113543	SWITCH – deck shift – Hydraulic Shift Headers only (was 42257) ..	1	-131619
	109063	SWITCH – deck shift – Hydraulic Shift Headers only	1	131620-
6	108074	SWITCH – toggle, header engage	1	-124499
	108224	SWITCH – toggle, header engage	1	124500-131619
7	108223	GUARD – header engage switch	1	-124499
	42841	GUARD – header engage switch	1	124500-131619
8	30215	RELAY	2	-131619
9	108191	COVER – switch panel	1	
10	39272	HOLDER – harness	1	
11	108192	MOUNT – switch panel, TV140 tractor only	1	
12	108159	HARNESS – wiring, adapter lights	1	
13	16539	LIGHT – amber	2	-124499
14	33860	CONDUIT – harness protector at R/H light	1	-124499
15	113511	LIGHT – amber, rectangular – includes M5 hardware	2	124500-
		BULB – replacement # 1156		
16	45156	CONDUIT – harness protector	2	124500-
17	49415	SUPPORT – switch	1	
18	49414	HARNESS – wiring, neutral switch	1	
19	30009	SWITCH – neutral	1	
20	18600	WASHER – flat, 21/32 ID X 1-5/16 inch	1	
21	45434	SPACER – tube	2	
A	42292	SCREW – self-tapping, Type A, hex washer head, #10 x 1/2 inch		
B	18638	WASHER – lock, 1/2 inch		
C	6771	NUT – hex, 1/2 NF		
D	21926	BOLT – round head, square neck, 1/4 NC x 1/2 inch		
E	21455	NUT – serrated flange lock, 1/4 NC		
F	21579	BOLT – hex head, 3/8 NC x 3-1/4 inch		
G	18598	WASHER – flat, 13/32 inch ID.		
H	30955	SCREW – self drilling, self tapping, #12 x 1 inch		
J	18796	NUT – hex, #8 NC		

HEADER COMPLETION GROUP

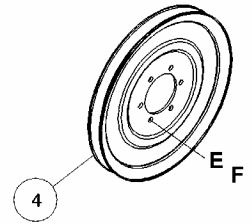
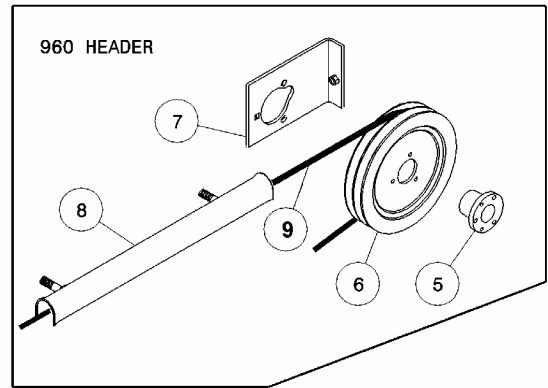
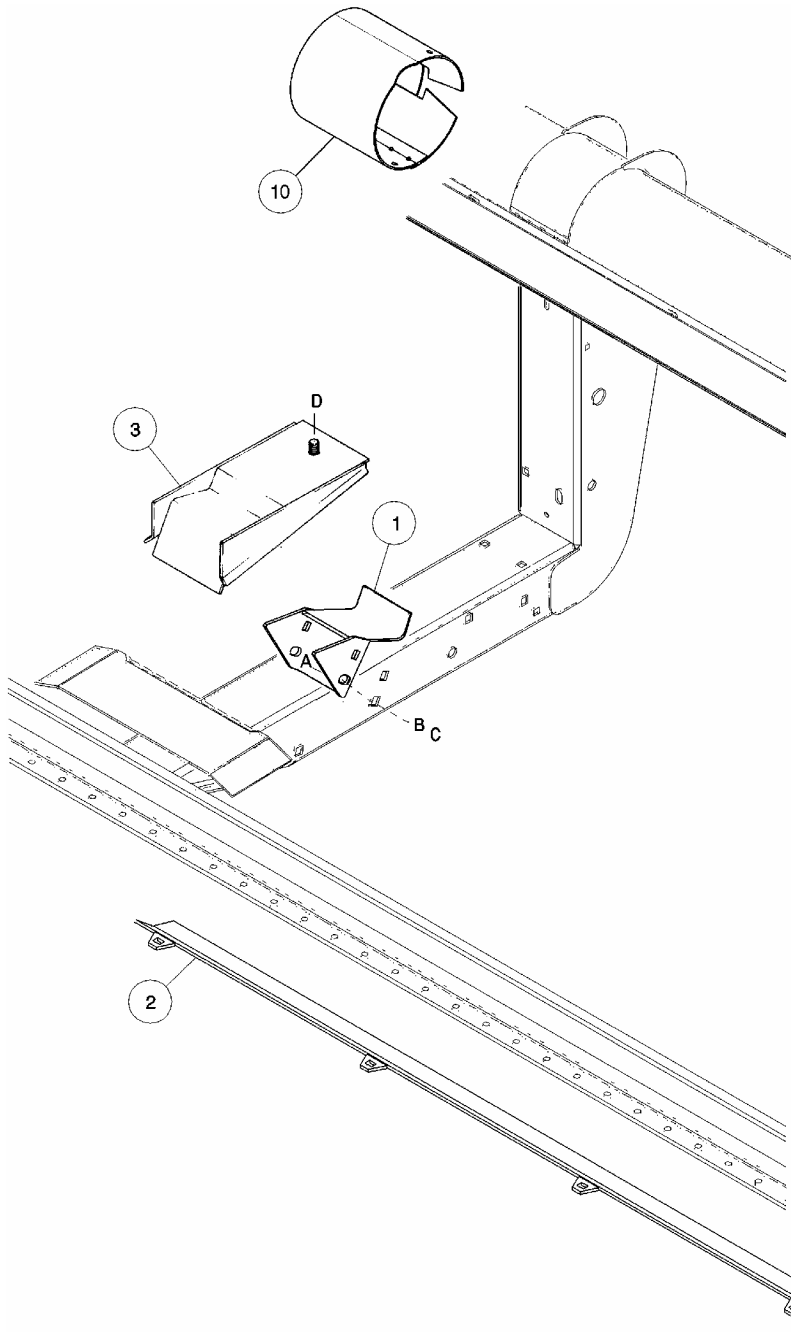

HEADER COMPLETION GROUP

REF	PART NUMBER	DESCRIPTION	QTY.	SERIAL NUMBER
1	117036	ADAPTER – pocket for adapter leg, 972 Headers (was 102428).....	2	
2	102412	PLATE – wear, center section, 972 Headers	1	
3	43301	ADAPTER – pocket for adapter leg, 960 & 962 Headers	2	
4	100050	PULLEY – 13” O.D., sickle drive for 962 & 972 Headers.....	1	
5	37104	BUSHING – split taper, sickle drive pulley, 960 Headers	1	
6	108108	PULLEY – sickle drive, (use inner groove), 960 Headers.....	1	
7	108150	BRACKET – belt tightener, 960 Headers	1	
8	108157	GUIDE – belt, upper strand, 960 Headers	1	
9	38151	BELT – sickle drive, 960 Headers	1	
10	108518	SHIELD – driveline, 972 header.....	1	138025-
A	117028	BOLT – round head, square neck, 5/8 NC x 6-1/2 inch		
B	18639	WASHER – lock, 5/8 inch		
C	18592	NUT – hex, 5/8 NC		
D	18666	NUT – lock, 5/8 NC distorted thread		
E	18637	WASHER – lock, 3/8 inch		
F	20077	BOLT – hex head, 3/8 NC x 1 inch		

DECALS

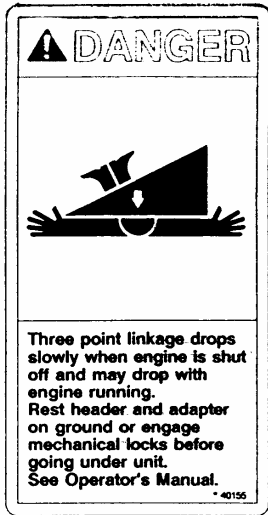

1

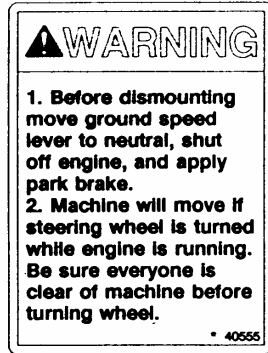

2

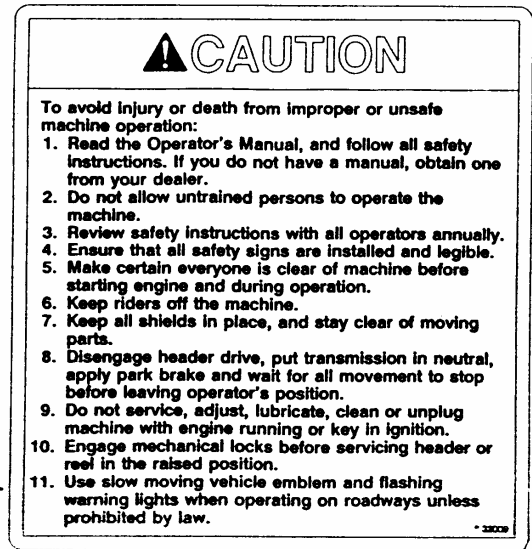

3



7



5

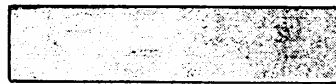

6

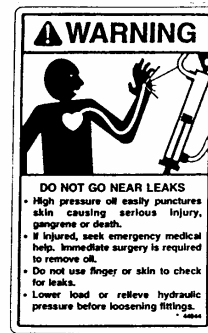

8

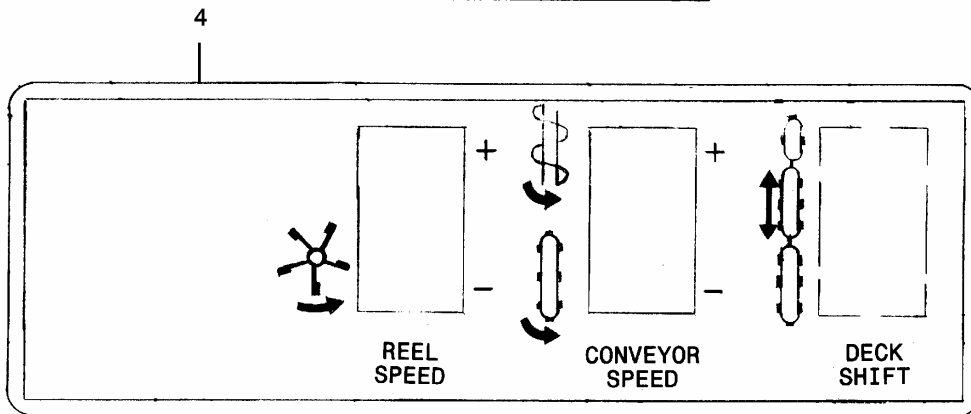

DECALS

REF	PART NUMBER	DESCRIPTION	QTY.	SERIAL NUMBER
1	40155	DECAL – Danger: Three Point Linkage	2	
2	40555	DECAL – Warning: Controls to Neutral	1	
3	32009	DECAL – Caution: General Safety	1	
4	108083	DECAL – Switch Panel	1	-131619
	108283	DECAL – Switch Panel (shown)	1	131620-
5	23165	DECAL – 50 Hour Grease	2	
6	26697	REFLECTOR – amber	2	
7	26694	REFLECTOR – red	2	
8	44944	DECAL – Warning: Hydraulic Oil Leaks	1	

NUMERICAL LIST

<u>PART NO.</u>	<u>PAGE</u>	<u>PART NO.</u>	<u>PAGE</u>	<u>PART NO.</u>	<u>PAGE</u>		
1134	3	36848	7	49414	11	108513	9
5512	5	37104	13	49415	11	108515	7
7900	5	37635	3	49417	7	108516	7
11695	3	38151	13	50018	7	108518	13
16539	11	39272	11	50077	9	108519	7
18600	11	40155	15	50082	7	108521	9
18648	5	40241	9	50086	7	108522	3
18671	3	40333	7	50105	7	108523	11
20312	3	40512	7	50106	3	108524	3
21376	5	40545	3	50193	7	109063	11
21395	5	40554	3	100050	13	113511	11
21540	3	40555	15	100790	9	113543	11
21540	5	40567	7	102412	13	114141	9
21719	5	40569	7	103738	7	117036	13
21830	7	40611	3	108063	7	135005	9
21832	9	40613	3	108065	7	135006	3
21855	7	40615	3	108066	7	158635	3
21856	7	40617	3	108074	11		
21857	7	40682	7	108077	11		
21858	9	40691	3	108080	11		
22072	3	40695	7	108082	11		
23165	15	40720	3	108083	15		
24322	3	40758	3	108093	7		
24508	9	41122	3	108099	3		
25298	3	41155	5	108108	13		
26694	15	42256	11	108110	7		
26697	15	42257	11	108121	3		
30009	11	42369	7	108133	7		
30215	11	42498	3	108134	7		
30262	9	42690	3	108136	7		
30446	5	42691	3	108141	7		
30516	5	43301	13	108150	13		
30517	5	43617	7	108155	7		
30520	5	44195	9	108157	13		
30521	5	44210	7	108159	11		
30610	7	44210	7	108160	7		
30695	7	44575	3	108161	3		
30710	11	44944	15	108175	7		
30758	5	45101	7	108191	11		
30858	7	45104	7	108192	11		
30871	7	45107	7	108223	11		
30971	7	45109	7	108224	11		
30971	7	45110	7	108226	9		
30973	7	45111	7	108267	11		
31802	9	45123	7	108283	15		
31805	9	45156	11	108284	11		
32009	15	45298	7	108285	11		
32225	7	45434	11	108501	9		
33860	11	45858	3	108502	9		
36837	3	49341	3	108505	3		